



AFCO Wiring Harness Installation Instructions

Jumper Negative Switch Relay Heat Shrink Positive Switch Fuse Holder Fusible Link

Components Needed

- Toggle Switch (Positively wired) (AFCO part # 85260)
- Temperature Switch (Negatively wired) (AFCO part # 85286)



Single Harness Shown

Fan Leads Connectors Harness Ground Ignition Wire Switch Leads Positive Leads

LIT 713

AFCO Wiring Harness Installation Instructions



1. Remove the harness and items from the bag. Check to ensure all the components have been included (Dual harness items in parenthesis).
2. Mount the relay(s) and fuse holder(s) on the firewall, inner fender, or another location away from any heat source. Also, make sure the red wires are long enough to reach the power source, battery or fuse box, and the green and black (and blue and black) wire leads are long enough to reach the fan(s) (Fig. 1).

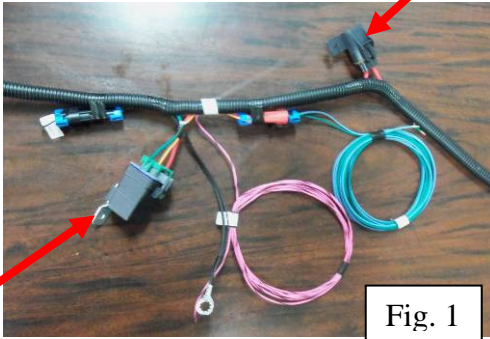

Fig. 1

3. Attach the eyelet(s) with the two black wires to a ground (Fig. 2).

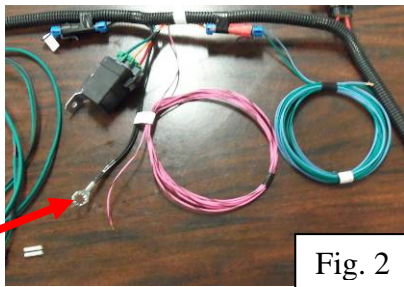

Fig. 2

4. Cut the red, green, and black wires to length once mounted in place (Fig. 3 & 5).
5. Attach the green wire to the positive fan wire and the black wire to the ground of the fan using the supplied connectors and heat shrink (Fig. 3).

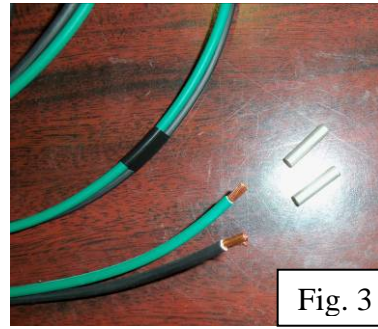

Fig. 3

6. The pink wire will be ran to the ignition wire of the vehicle if you want the fan to only run while the vehicle is on. If you want the fan to run anytime the vehicle is above the specified temperature (ignition off or on), then run the pink/black wire to your power source (Fig. 4).

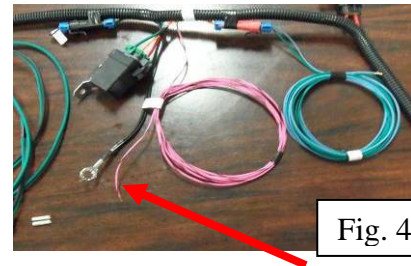

Fig. 4

7. Attach the fusible link(s) to the red wire(s) and the other end will be attached to the battery or power source. Do not connect to the power source until everything is wired completely. The fusible link is an added safety feature based upon the length of wire being used (Fig. 5).

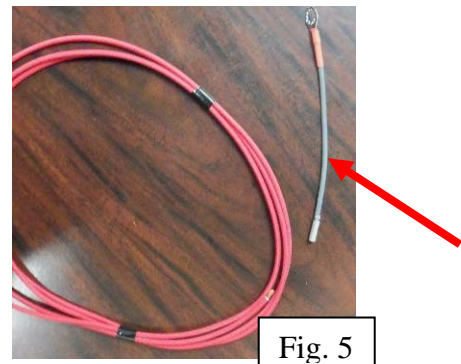

Fig. 5

AFCO Wiring Harness Installation Instructions



8. The last step consists of wiring the fans to be controlled positively (by the use of a toggle switch), or negatively (by a temperature grounding switch). The components below control the switching operation of the harness (Fig. 6).



Fig. 6

9. If the car will be positively wired, a toggle switch will be needed. If the car will be negatively wired, an electric fan temperature switch will be needed (AFCO part # 85286) (Fig. 11).
10. In order to wire the car for the positive switch, the jumper should be installed into the black connector (Fig. 7) of the harness and the green and blue leads should be connected to the red connector (Fig. 8). The blue and green wires will then run to your toggle switch.

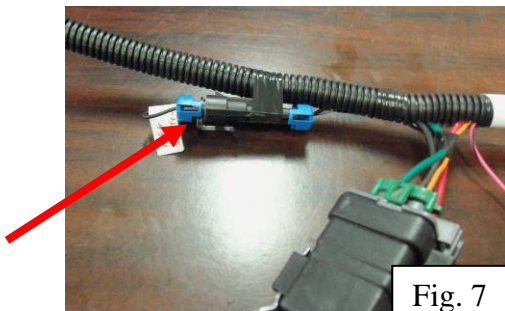

Fig. 7

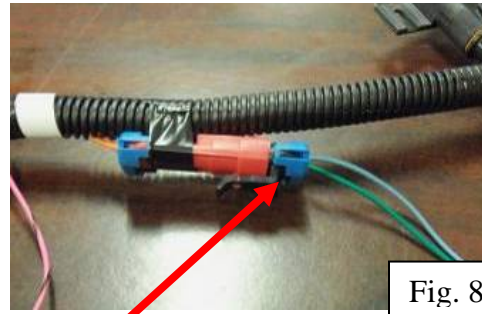

Fig. 8

11. If the car will be wired for a ground switch, the jumper will be installed into the red connector (Fig. 9) and the blue and green leads will connect to the black connector (Fig. 10). Then, the green wire can be discarded and the blue wire will attach to the electric fan temperature switch (Fig. 11). At this time the fan harness will be functional.

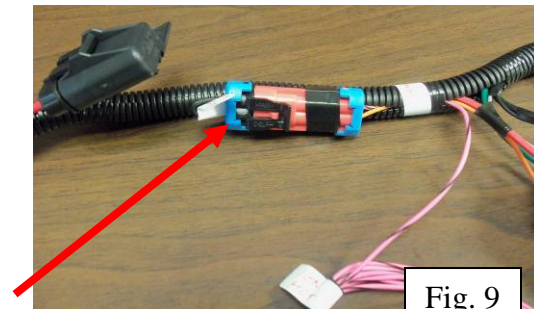

Fig. 9

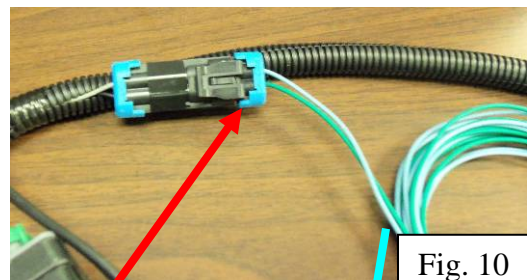

Fig. 10

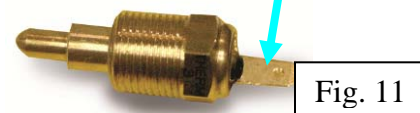

Fig. 11